

轻松选择合适的油烟机

有上柜—安装橱柜下

如下图所示，请测量橱柜的宽度A，并判断您家的灶具是下列哪一款？
根据判断，请在下方找到对应选项，进行下一步

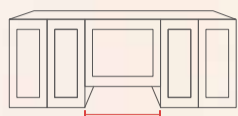

A 30in



橱柜宽度30in

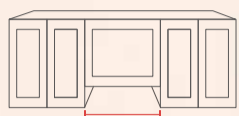

A 36in



橱柜宽度36in

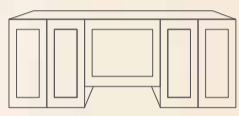

灶烤一体机

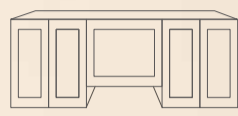

嵌入式灶具

橱柜宽度30in 灶烤一体机

请测量橱柜到灶具最高点的距离C
若距离C小于19in，很遗憾，方太暂时没有合适的机型；
若距离C大于19in，请继续测量橱柜底部到台面的距离B
并根据所测距离，从右侧表格中选择适合您的烟机

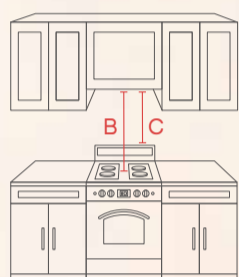

橱柜底部到台面的距离B	适合您的方太油烟机	备注
29.5-32.5in		最佳安装尺寸
32.5-33.5in	侧吸式： JQG7501	略高于最佳安装尺寸，您可以选择： 1. 将烟机安装在31.5in，然后在烟机顶部和橱柜之间，安装橱柜filler 2. 或将烟机安装在橱柜底部，除非猛火爆炒，否则效果几乎无影响
33.5-36.5in	JQG7501.G JQG7502 JQG7502.G	安装尺寸偏高，为保证最佳吸油烟效果，建议您： 购买4in装饰板*
36.5-38.5in	JQG7522 (Amazon特供款)	安装尺寸偏高，为保证最佳吸油烟效果，建议您： 购买6in装饰板*
高于38.5in		安装尺寸高，为保证最佳吸油烟效果，建议您： 将油烟机安装在31.5in，增加橱柜filler

橱柜宽度30in 嵌入式灶具

请测量橱柜到灶具最高点的距离B
若距离B小于29in，很遗憾，方太暂时没有合适的机型；
若距离B大于29in，根据所测距离
从右侧表格中选择适合您的烟机

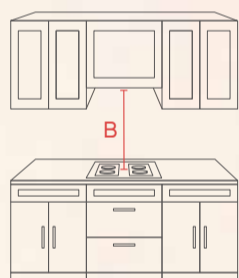

橱柜底部到台面的距离B	适合您的方太油烟机	备注
29.5-32.5in		最佳安装尺寸
32.5-33.5in	侧吸式： JQG7501	略高于最佳安装尺寸，您可以选择： 1. 将烟机安装在31.5in，然后在烟机顶部和橱柜之间，安装橱柜filler 2. 或将烟机安装在橱柜底部，除非猛火爆炒，否则效果几乎无影响
33.5-36.5in	JQG7501.G JQG7502 JQG7502.G	安装尺寸偏高，为保证最佳吸油烟效果，建议您： 购买4in装饰板*
36.5-38.5in	JQG7522 (Amazon特供款)	安装尺寸偏高，为保证最佳吸油烟效果，建议您： 购买6in装饰板*
高于38.5in		安装尺寸高，为保证最佳吸油烟效果，建议您： 将油烟机安装在31.5in，增加橱柜filler

橱柜宽度36in 灶烤一体机

请测量橱柜到灶具最高点的距离C
若距离C小于19in，很遗憾，方太暂时没有合适的机型；
若距离C大于19in，请继续测量橱柜底部到台面的距离B
并根据所测距离，从右侧表格中选择适合您的烟机

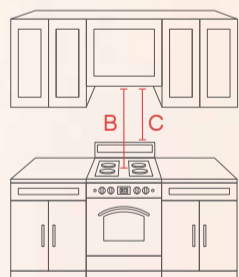

橱柜底部到台面的距离B	适合您的方太油烟机	备注
29.5-32.5in		最佳安装尺寸
32.5-33.5in		略高于最佳安装尺寸，您可以选择： 1. 将烟机安装在31.5in，然后在烟机顶部和橱柜之间，安装橱柜filler 2. 或将烟机安装在橱柜底部，除非猛火爆炒，否则效果几乎无影响
33.5-36.5in	侧吸式JQG9001	安装尺寸偏高，为保证最佳吸油烟效果，建议您： 购买4in装饰板*
36.5-38.5in		安装尺寸偏高，为保证最佳吸油烟效果，建议您： 购买6in装饰板*
高于38.5in		安装尺寸高，为保证最佳吸油烟效果，建议您： 将油烟机安装在31.5in，增加橱柜filler

橱柜宽度36in 嵌入式灶具

请测量橱柜到灶具最高点的距离B
若距离B小于29in，很遗憾，方太暂时没有合适的机型；
若距离B大于29in，根据所测距离
从右侧表格中选择适合您的烟机

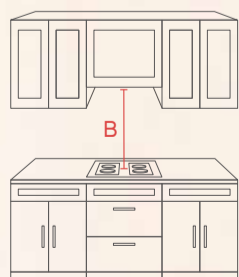

橱柜底部到台面的距离B	适合您的方太油烟机	备注
29.5-32.5in		最佳安装尺寸
32.5-33.5in		略高于最佳安装尺寸，您可以选择： 1. 将烟机安装在31.5in，然后在烟机顶部和橱柜之间，安装橱柜filler 2. 或将烟机安装在橱柜底部，除非猛火爆炒，否则效果几乎无影响
33.5-36.5in	侧吸式JQG9001	安装尺寸偏高，为保证最佳吸油烟效果，建议您： 购买4in装饰板*
36.5-38.5in		安装尺寸偏高，为保证最佳吸油烟效果，建议您： 购买6in装饰板*
高于38.5in		安装尺寸高，为保证最佳吸油烟效果，建议您： 将油烟机安装在31.5in，增加橱柜filler



方太微信客服

Toll Free:
888-315-0366

*装饰板及装饰罩，零售门店及Amazon均有销售

轻松选择合适的油烟机

无上柜一带罩式安装 橱柜宽度30in

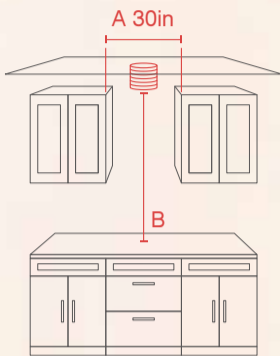

如左图所示，请测量
橱柜的宽度A

判断您家的橱柜宽度是30in

如左图所示，请测量
台面到烟道口最底端的距离B

若距离B小于40in
很抱歉，您需要调整烟道高度
选购产品前，请咨询方太客服；
若距离B在40-53in或大于53in
请在下方找到对应选项，进行下一步

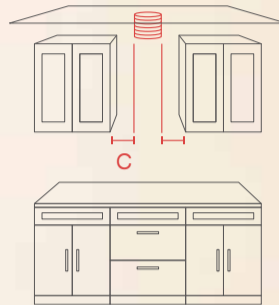

如左图所示，请测量
烟道口的弧形边缘
距相应的橱柜边缘的尺寸C

若任何一边尺寸小于9in
可能导致无法安装装饰罩而使烟管、烟道外露
建议您选购产品前，咨询方太客服；
若两边尺寸均大于9in
请根据距离B在下方找到对应选项，进行下一步

| 台面距烟道口40-53in

- 1.请测量插座底部到台面的距离D。若D小于32in，则您需要更改插座位置，建议您咨询方太客服
- 2.请测量天花板至台面的距离E，并根据所测距离，从以下表格中选择适合您的油烟机

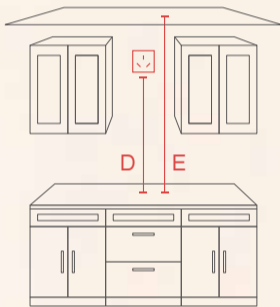

天花板至台面的距离E	适合您的方太油烟机	备注
45-60in	侧吸式： JQG7501、JQG7501.G、 JQG7502、JQG7502.G、 JQG7522（亚马逊特供款）	标准尺寸，需购买： 装饰罩*
60-74in		略高尺寸，需购买： 装饰罩+加长700mm装饰罩*
74-82in		超高尺寸，需购买： 装饰罩+加长900mm装饰罩*

| 台面距烟道口大于53in

- 1.请测量插座底部到台面的距离D。侧吸式油烟机D需大于32in，顶吸式油烟机D需大于48in。若您家需要更改插座位置，建议您咨询方太客服
- 2.请测量天花板至台面的距离E，并根据所测距离，从以下表格中选择适合您的油烟机

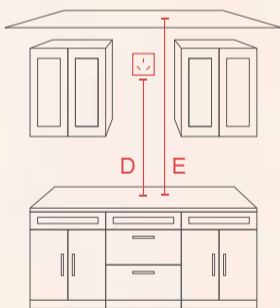

天花板至台面的距离E	适合您的方太油烟机	备注
45-50in	侧吸式：JQG7501、JQG7501.G JQG7502、JQG7502.G JQG7522（亚马逊特供款）	标准尺寸，需购买： 装饰罩*
50-60in	顶吸式： EH17A、EH13、EH11D 侧吸式： JQG7501、JQG7501.G、 JQG7502、JQG7502.G、 JQG7522（亚马逊特供款）	购买侧吸式油烟机，需购买： 装饰罩*
60-63in		购买侧吸式油烟机，需购买： 装饰罩+加长700mm装饰罩*
63-74in		购买侧吸式油烟机，需购买： 装饰罩+加长700mm装饰罩* 购买顶吸式油烟机，需购买： 加长700mm装饰罩*
74-77in		购买侧吸式油烟机，需购买： 装饰罩+加长900mm装饰罩* 购买顶吸式机型，需购买： 加长700mm装饰罩*
77-82in		购买侧吸式油烟机，需购买： 装饰罩+加长900mm装饰罩* 购买顶吸式油烟机，需购买： 加长900mm装饰罩*
82-85in	顶吸式： EH17A、EH13、EH11D	需购买： 加长900mm装饰罩*



方太微信客服

Toll Free:
888-315-0366

*装饰板及装饰罩，零售门店及Amazon均有销售

轻松选择合适的油烟机

无上柜一带罩式安装 橱柜宽度36in

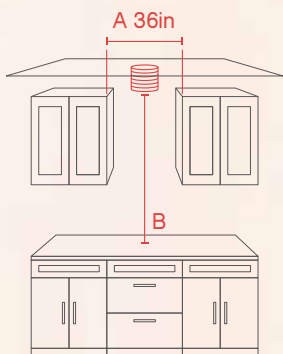

如左图所示，请测量
橱柜的宽度A

判断您家的橱柜宽度是36in

如左图所示，请测量
台面到烟道口最底端的距离B

若距离B小于40in
很抱歉，您需要调整烟道高度
选购产品前，请咨询方太客服；
若距离B在40-53in或大于53in
请在下方找到对应选项，进行下一步

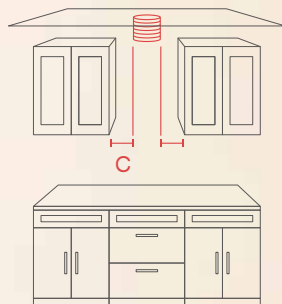

如左图所示，请测量
烟道口的弧形边缘
距相应的橱柜边缘的尺寸C

若任何一边尺寸小于11in
可能导致无法安装装饰罩而使烟管、烟道外露
建议您选购产品前，咨询方太客服；
若两边尺寸均大于11in
请根据距离B在下方找到对应选项，进行下一步

| 台面距烟道口40-53in

- 1.请测量插座底部到台面的距离D，若D小于32in，则您需要更改插座位置，建议您咨询方太客服
- 2.请测量天花板至台面的距离E，并根据所测距离，从以下表格中选择适合您的油烟机

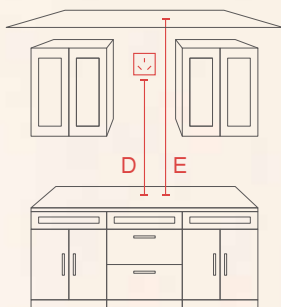

天花板至台面的距离E	适合您的方太油烟机	备注
45-60in	侧吸式 JQG9001	标准尺寸，需购买： 装饰罩*
60-74in		略高尺寸，需购买： 装饰罩+加长700mm装饰罩*
74-82in		超高尺寸，需购买： 装饰罩+加长900mm装饰罩*

| 台面距烟道口大于53in

- 1.请测量插座底部到台面的距离D。侧吸式油烟机D需大于32in，顶吸式油烟机D需大于48in。若您家需要更改插座位置，建议您咨询方太客服
- 2.请测量天花板至台面的距离E，并根据所测距离，从以下表格中选择适合您的油烟机

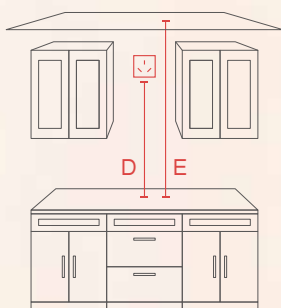

天花板至台面的距离E	适合您的方太油烟机	备注
45-53in	侧吸式 JQG9001	需购买： 装饰罩*
53-60in	侧吸式 JQG9001 顶吸式 EMS9018、EMS9016	购买侧吸式油烟机，需购买： 装饰罩*
60-65in		购买侧吸式油烟机，需购买： 装饰罩+加长700mm装饰罩*
65-74in		购买侧吸式油烟机，需购买： 装饰罩+加长700mm装饰罩* 购买顶吸式油烟机，需购买： 700mm装饰罩*
74-79in		购买侧吸式油烟机，需购买： 装饰罩+加长900mm装饰罩* 购买顶吸式油烟机，需购买： 700mm装饰罩*
79-82in		购买侧吸式油烟机，需购买： 装饰罩+加长900mm装饰罩* 购买顶吸式油烟机，需购买： 900mm装饰罩*
82-87in	顶吸式 EMS9018、EMS9016	需购买： 900mm装饰罩*



方太微信客服

Toll Free:

888-315-0366

*装饰板及装饰罩，零售门店及Amazon均有销售

Choose the Right FOTILE Range Hood for Your Kitchen

With Upper Cabinet

As shown in the following figure, please measure the width A of the cabinet. And select the model of your kitchen range.

According to the judgment, find the option below and proceed to the next step.



Cabinet Width 30in

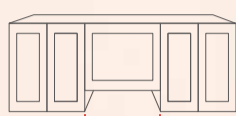

Cabinet Width 36in

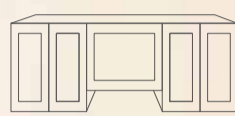

Freestanding Range

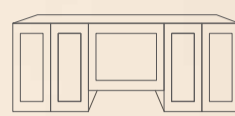

Build-in cooktop

Cabinet Width 30in Freestanding Range

Please measure the distance C from the cabinet to the highest point of the kitchen range.

If $C < 19$ in, sorry, there's no suitable range hood for you.

If $C > 19$ in, please measure the distance B from the bottom of the cabinet to the countertop.

According to the measured distance, from the right table to select your range hood.

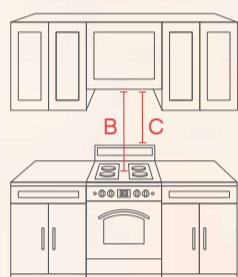

B	Recommendation	Note
29.5-32.5in		Optimal installation size
32.5-33.5in	Side-draft: JQG7501 JQG7501.G	Slightly higher than optimal installation height. You may: 1. Install the range hood at the height of 31.5in, then install the cabinet filler between the top of the range hood and the cabinet 2. Or install the range hood at the bottom of the cabinet, which is of little effect except stir-fry with intensive fire
33.5-36.5in	JQG7502 JQG7502.G	The installation size is slightly higher, to guarantee optimal smoke control effects, we recommend you to buy 4in finish*
36.5-38.5in	JQG7522 (Amazon Model)	The installation size is slightly higher, to guarantee optimal smoke control effects, we recommend you to buy 6in finish*
> 38.5in		Higher than optimal installation height, You may install the range hood at the height of 31.5in, then install the cabinet filler between the top of the range hood and the cabinet

Cabinet Width 30in Build-in cooktop

Please measure the distance B from the cabinet to the highest point of the kitchen range.

If $B < 29$ in, sorry, there's no suitable range hood for you.

If $B > 29$ in, please measure the distance B from the bottom of the cabinet to the countertop.

According to the measured distance, from the right table to select your range hood.

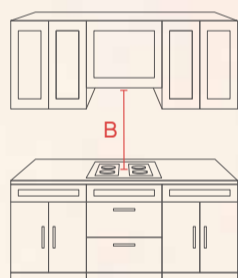

B	Recommendation	Note
29.5-32.5in		Optimal installation size
32.5-33.5in	Side-draft: JQG7501 JQG7501.G	Slightly higher than optimal installation height. You may: 1. Install the range hood at the height of 31.5in, then install the cabinet filler between the top of the range hood and the cabinet 2. Or install the range hood at the bottom of the cabinet, which is of little effect except stir-fry with intensive fire
33.5-36.5in	JQG7502 JQG7502.G	The installation size is slightly higher, to guarantee optimal smoke control effects, we recommend you to buy 4in finish*
36.5-38.5in	JQG7522 (Amazon Model)	The installation size is slightly higher, to guarantee optimal smoke control effects, we recommend you to buy 6in finish*
> 38.5in		Higher than optimal installation height, You may install the range hood at the height of 31.5in, then install the cabinet filler between the top of the range hood and the cabinet

Cabinet Width 30in Freestanding Range

Please measure the distance C from the cabinet to the highest point of the kitchen range.

If $C < 19$ in, sorry, there's no suitable range hood for you.

If $C > 19$ in, please measure the distance B from the bottom of the cabinet to the countertop.

According to the measured distance, from the right table to select your range hood.

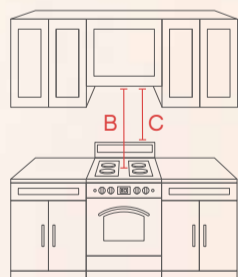

B	Recommendation	Note
29.5-32.5in		Optimal installation size
32.5-33.5in	Side-draft: JQG9001	Slightly higher than optimal installation height. You may: 1. Install the range hood at the height of 31.5in, then install the cabinet filler between the top of the range hood and the cabinet 2. Or install the range hood at the bottom of the cabinet, which is of little effect except stir-fry with intensive fire
33.5-36.5in	JQG9001	The installation size is slightly higher, to guarantee optimal smoke control effects, we recommend you to buy 4in finish*
36.5-38.5in		The installation size is slightly higher, to guarantee optimal smoke control effects, we recommend you to buy 6in finish*
> 38.5in		Higher than optimal installation height, You may install the range hood at the height of 31.5in, then install the cabinet filler between the top of the range hood and the cabinet

Cabinet Width 36in Build-in cooktop

Please measure the distance B from the cabinet to the highest point of the kitchen range.

If $B < 29$ in, sorry, there's no suitable range hood for you.

If $B > 29$ in, please measure the distance B from the bottom of the cabinet to the countertop.

According to the measured distance, from the right table to select your range hood.

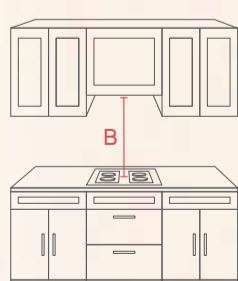

B	Recommendation	Note
29.5-32.5in		Optimal installation size
32.5-33.5in	Side-draft: JQG9001	Slightly higher than optimal installation height. You may: 1. Install the range hood at the height of 31.5in, then install the cabinet filler between the top of the range hood and the cabinet 2. Or install the range hood at the bottom of the cabinet, which is of little effect except stir-fry with intensive fire
33.5-36.5in	JQG9001	The installation size is slightly higher, to guarantee optimal smoke control effects, we recommend you to buy 4in finish*
36.5-38.5in		The installation size is slightly higher, to guarantee optimal smoke control effects, we recommend you to buy 6in finish*
> 38.5in		Higher than optimal installation height, You may install the range hood at the height of 31.5in, then install the cabinet filler between the top of the range hood and the cabinet

Choose the Right FOTILE Range Hood for Your Kitchen

Without Upper Cabinet - Cabinet width 30in

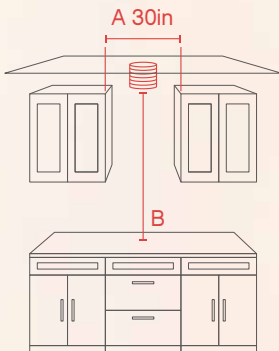

As shown in the left figure, please measure the width A of the cabinet is 30in

Please measure the distance B from the countertop to the bottom of the duct

If $B < 40in$, sorry, there's no suitable range hood for you.

If $B > 40in$, please find the option below and proceed to the next step.

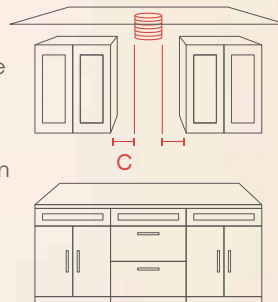

As shown in the left figure, please measure the width C (the distance between the arc edge of the duct to the corresponding cabinet edge)

If smaller than 9in on either side, the duct may be exposed, please consider it carefully or consult us before decision.

If bigger than 9in on either side, please find the option below according to the size B.

| B 40-53in

1. Please measure the distance D (from the bottom of the plug to the countertop). If $D < 32in$, you may have to move the plug, please consult us.

2. Please measure the distance E (from the ceiling to the countertop), according to the measured distance, from the table to select your range hood.

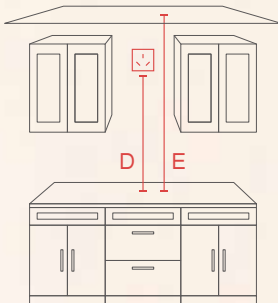

E	Recommendation	Note
45-60in	Side-draft: JQG7501、JQG7501.G、 JQG7502、JQG7502.G、 JQG7522(Amazon Model)	Optimal installation size, buy: Decorative cover
60-74in		Slightly higher than optimal installation height, buy: Decorative cover+700mm extended decorative cover*
74-82in		Higher than optimal installation height, buy: Decorative cover+900mm extended decorative cover*

| B 40 > 53in

1. Please measure the distance D (from the bottom of the plug to the countertop). For side-draft hood, $D > 32in$ while overhead hood, $D > 48in$. If you have to move the plug, please consult us.

2. Please measure the distance E (from the ceiling to the countertop), according to the measured distance, from the table to select your range hood.

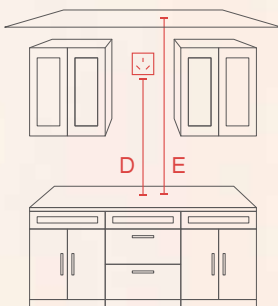

E	Recommendation	Note
45-50in	Side-draft: JQG7501、JQG7501.G JQG7502、JQG7502.G JQG7522(Amazon Model)	Optimal installation size, buy: Decorative cover
50-60in	Overhead: EH17A、EH13、EH11D Side-draft: JQG7501、JQG7501.G、 JQG7502、JQG7502.G、 JQG7522(Amazon Model)	Side-draft hood, buy: Decorative cover
60-63in		Side-draft hood, buy: Decorative cover+700mm extended decorative cover*
63-74in		Side-draft hood, buy: Decorative cover+700mm extended decorative cover* Overhead hood, buy: 700mm extended decorative cover*
74-77in	Side-draft hood, buy: Decorative cover+900mm extended decorative cover* Overhead hood, buy: 700mm extended decorative cover*	Side-draft hood, buy: Decorative cover+900mm extended decorative cover* Overhead hood, buy: 700mm extended decorative cover*
77-82in		Side-draft hood, buy: Decorative cover+900mm extended decorative cover* Overhead hood, buy: 900mm extended decorative cover*
82-85in	Overhead: EH17A、EH13、EH11D	Overhead hood, buy: 900mm extended decorative cover*



FOTILE Wechat Service

Toll Free:
888-315-0366

*4in and 6in finish panel is available in FOTILE retail stores and Amazon store.

Choose the Right FOTILE Range Hood for Your Kitchen

Without Upper Cabinet - Cabinet width 36in

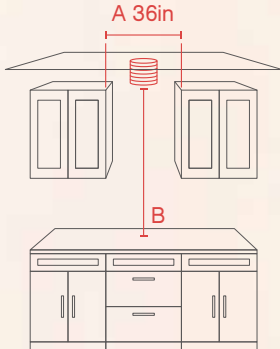

As shown in the left figure, please measure the width A of the cabinet is 36in

Please measure the distance B from the countertop to the bottom of the duct

If $B < 40$ in, sorry, there's no suitable range hood for you.

If $B > 40$ in, please find the option below and proceed to the next step.

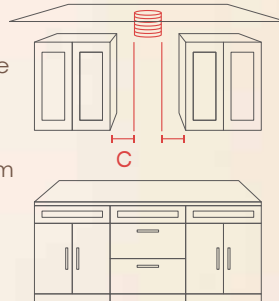

As shown in the left figure, please measure the width C (the distance between the arc edge of the duct to the corresponding cabinet edge)

If smaller than 11in on either side, the duct may be exposed, please consider it carefully or consult us before decision. If bigger than 11in on either side, please find the option below according to the size B.

| B 40-53in

1. Please measure the distance D (from the bottom of the plug to the countertop). If $D < 32$ in, you may have to move the plug, please consult us.
2. Please measure the distance E (from the ceiling to the countertop), according to the measured distance, from the table to select your range hood.

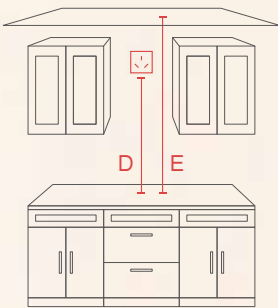

E	Recommendation	Note
45-60in	Side-draft: JQG9001	Optimal installation size, buy: Decorative cover
60-74in		Slightly higher than optimal installation height, buy: Decorative cover+700mm extended decorative cover*
74-82in		Higher than optimal installation height, buy: Decorative cover+900mm extended decorative cover*

| B 40 > 53in

1. Please measure the distance D (from the bottom of the plug to the countertop). For side-draft hood, $D > 32$ in while overhead hood, $D > 48$ in. If you have to move the plug, please consult us.
2. Please measure the distance E (from the ceiling to the countertop), according to the measured distance, from the table to select your range hood.

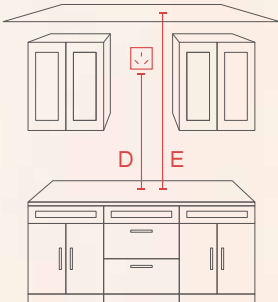

E	Recommendation	Note
45-53in	Side-draft: JQG9001	Optimal installation size, buy: Decorative cover
53-60in	Side-draft: JQG9001 Overhead: EMS9018、EMS9016	Side-draft hood, buy: Decorative cover
60-65in		Side-draft hood, buy: Decorative cover+700mm extended decorative cover*
65-74in		Side-draft hood, buy: Decorative cover+700mm extended decorative cover* Overhead hood, buy: 700mm extended decorative cover*
74-79in		Side-draft hood, buy: Decorative cover+900mm extended decorative cover* Overhead hood, buy: 700mm extended decorative cover*
79-82in		Side-draft hood, buy: Decorative cover+900mm extended decorative cover* Overhead hood, buy: 900mm extended decorative cover*
82-87in		Overhead: EMS9018、EMS9016



FOTILE Wechat Service

Toll Free:
888-315-0366

*4in and 6in finish panel is available in FOTILE retail stores and Amazon store.